

# CRYSTAL SYMPHONY

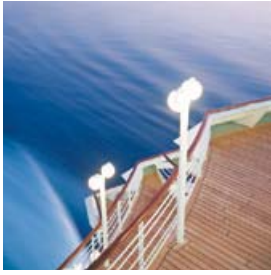

## CRYSTAL SYMPHONY

Guest capacity: 922  
 Per guest space ratio: 55.3  
 Per guest staff ratio: 0.59  
 Ship's registry: The Bahamas  
 Gross registered tons: 51,044  
 Length: 781 ft. (238.1 m)  
 Width: 99.1 ft. (30.2 m)  
 Draft: 24.9 ft. (7.6 m)  
 Cruising speed: 20 knots



## OFFICERS

European Captains  
 International officers



## INTERNATIONAL CREW

Countries represented: 45  
 European-trained hotel & dining staff  
 Total crew: 566



## CRYSTAL SYMPHONY DIRECTORY

ACTIVITIES	DECK
Avenue of the Stars Shops	6
Apropos	
Facets	
Crystal Collection	
Bridge Lounge	6
Computer University@Sea	6
Fantasia	11
Library	6
Photo Shop	6
The Studio	6
Waves	11

DINING	DECK
The Bistro	6
Crystal Dining Room	5
Ice Cream Bar	11
Lido Café	11
Palm Court (Afternoon Tea)	11
Prego	6
Silk Road	6
The Sushi Bar	6
Trident Bar & Grill	11
The Vintage Room	6

ENTERTAINMENT	DECK
Avenue Saloon	6
Connoisseur Club	6
Crystal Casino	6
Crystal Cove	5
Galaxy Lounge	6
Hollywood Theatre	6
Luxe	6
Palm Court	11
Starlite Club	6

RECREATION & FITNESS	DECK
Crystal Spa & Salon	12
Fitness Center	12
Golf Driving Nets	12
Putting Green	12
Seahorse Pool	11
Shuffleboard Courts	7
Sun Deck	12
Table Tennis	8
Wimbledon Court	12

Sun Deck	12
Lido Deck	11
Penthouse Deck	10
Seabreeze Deck	9
Horizon Deck	8
Promenade Deck	7
Tiffany Deck	6
Crystal Deck	5
Excursion Deck	4

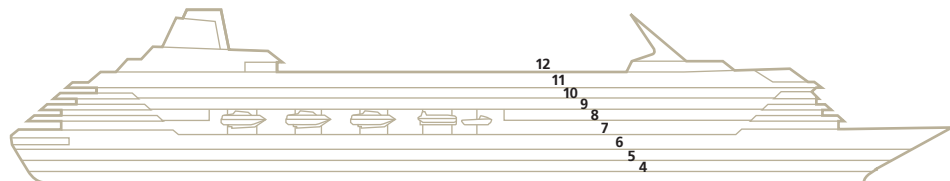

*Crystal Symphony was so spacious  
sometimes we thought we were on  
our own private cruise.*



# CRYSTAL SYMPHONY: CRYSTAL PENTHOUSE



Beginning June 2014:



## CRYSTAL PENTHOUSE WITH BUTLER SERVICE

982 sq. ft. (with verandah)

Please refer to the enclosed *Fare & Itinerary Guides* to view full ship deck plans.

- Spacious living room with custom wool carpets, walnut floors, cabinetry and Swarovski chandelier
- Dining area with panoramic ocean views
- Custom entertainment center with Samsung flat-panel television, Blu-ray DVD/CD players and Bose surround sound
- Separate study
- Custom built-in bar
- Aquavision television in bathroom
- Large bedroom with queen-size bed or twins with Frette linens, plus his and hers walk-in closets and flat-panel television with Blu-ray DVD/CD player
- Sophisticated one-touch lighting system
- Master bath with Jacuzzi, ocean view, crystal sconces and Calacatta marble floors, separate shower and bidet
- Large private verandah with teak furniture
- Complimentary wine plus choice of spirits from set menu upon embarkation
- Complimentary soft drinks, beer and bottled water in room
- Complimentary newspaper of your choice once daily
- Binoculars
- Cordless phone
- Wireless Internet access
- Guest bathroom
- Refrigerator
- Security safe
- A total of two private car/minivan transfers per voyage from/to the designated airport in the port city for embarkation and disembarkation or transfers to/from other locations within 100 miles of the port city for embarkation/disembarkation\*

### Additional Complimentary Crystal Penthouse Amenities

- Personal butler service
- Free unlimited Crystal e-mail
- Free unlimited Internet
- Free in-suite phone usage (2 hours per cruise)
- Free laundry and dry cleaning
- Free pressing service
- Private Captain's invitation Bridge tour (when operationally possible)

\*Restrictions apply. Services are nontransferable. There are no credits given for forfeited services. Note: car/minivan will be arranged according to the number of pieces of luggage.

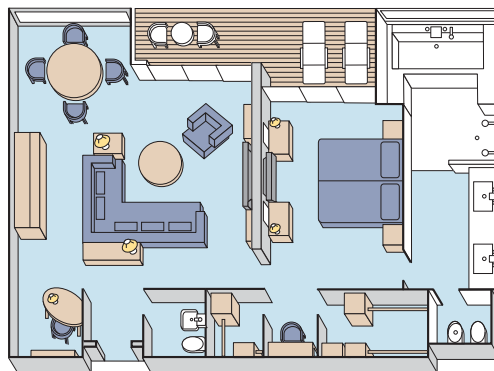





PENTHOUSE SUITE



PENTHOUSE

# CRYSTAL SYMPHONY: PENTHOUSES

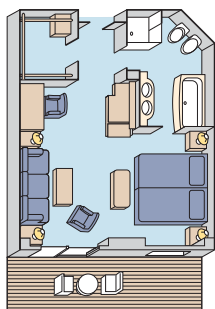

**PS**

Beginning June 2014:

**PS**

## PENTHOUSE SUITE WITH BUTLER SERVICE

491 sq. ft. (with verandah)

Please refer to the enclosed *Fare & Itinerary Guides* to view full ship deck plans.

- Spacious living area
- Private verandah
- Complimentary wine plus choice of spirits from set menu upon embarkation
- Complimentary soft drinks, beer and bottled water in room
- Wireless Internet access
- Two flat-panel televisions with DVD/CD player
- Queen-size bed or twin beds with sumptuous bedding, and third berth
- Full Jacuzzi bathtub
- Separate shower
- Bidet
- Walk-in closet
- Refrigerator
- Security safe
- Binoculars

### Additional Complimentary Penthouse Suite Amenities

- Personal butler service
- Free unlimited Crystal e-mail
- Free Internet (2 hours per cruise)
- Free in-suite phone usage (1 hour per cruise)
- Free pressing service

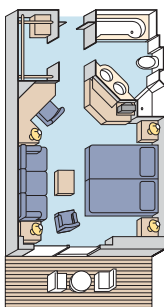

**PH**

Beginning June 2014:

**PH**

## PENTHOUSE WITH BUTLER SERVICE

367 sq. ft. (with verandah)

Please refer to the enclosed *Fare & Itinerary Guides* to view full ship deck plans.

- Sizeable living area
- Private verandah
- Complimentary wine plus choice of spirits from set menu upon embarkation
- Complimentary soft drinks, beer and bottled water in room
- Wireless Internet access
- Flat-panel television with DVD/CD player
- Queen-size bed or twin beds with sumptuous bedding, and third berth
- Full Jacuzzi bathtub
- Separate shower
- Walk-in closet
- Refrigerator
- Security safe
- Binoculars

### Additional Complimentary Penthouse Amenities

- Personal butler service
- Free unlimited Crystal e-mail
- Free pressing service



DELUXE STATEROOM WITH VERANDAH



DELUXE STATEROOM WITH LARGE PICTURE WINDOW

# CRYSTAL SYMPHONY: STATEROOMS

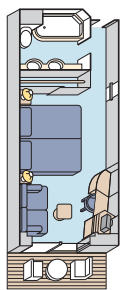

Beginning June 2014:



## DELUXE STATEROOM WITH VERANDAH

246 sq. ft. (with verandah)

Please refer to the enclosed *Fare & Itinerary Guides* to view full ship deck plans.

- Private verandah
  - Seating area
  - Queen-size bed or twin beds with sumptuous bedding
  - Complimentary soft drinks and bottled water in room
  - Complimentary select beer, wine and spirits upon request
  - Flat-panel television with DVD/CD player
  - Full bathtub/shower combination
  - Refrigerator
  - Security safe
- A3, B2:** forward  
**A2:** slightly limited view

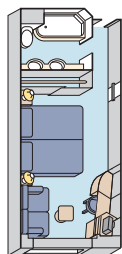

Beginning June 2014:



## DELUXE STATEROOM WITH LARGE PICTURE WINDOW

202 sq. ft.

Please refer to the enclosed *Fare & Itinerary Guides* to view full ship deck plans.

- Large picture window
  - Seating area
  - Queen-size bed or twin beds with sumptuous bedding
  - Complimentary soft drinks and bottled water in room
  - Complimentary select beer, wine and spirits upon request
  - Flat-panel television with DVD/CD player
  - Full bathtub/shower combination
  - C & D have sweeping views; E has a view that is limited or extremely limited
  - Refrigerator
  - Security safe
- C2:** forward  
**E1:** limited view  
**E2:** extremely limited view

Please note: Penthouse and stateroom photos and layouts shown are examples of what is available and do not necessarily reflect all rooms or latest refurbishments, including but not limited to staterooms for guests with disabilities. Penthouses specially designed for guests with disabilities do not feature third berth.